



SmartGlow™ Pre Stain, for Nucleic Acid Electrophoresis Gels, Concentration 20,000X

E4500-PS

SmartGlow™ Pre Stain can be used the same way as Ethidium Bromide for agarose and polyacrylamide gel electrophoresis. The stain emits green fluorescence when bound to dsDNA, ssDNA, and RNA. SmartGlow™ stain has two excitation peaks at approximately 290nm (UV light) and 475nm (Blue light).

SmartGlow™ Pre Stain is considered safer than Ethidium Bromide, and is non-carcinogenic as determined by the Ames-test, with negative results in mouse primary spermatocyte chromosomal aberration tests and mouse marrow chromophilous erythrocyte micronucleus tests. SmartGlow™ Pre Stain can be disposed as non-hazardous waste, and has passed the CCR Title 22 Hazardous Waste Test.

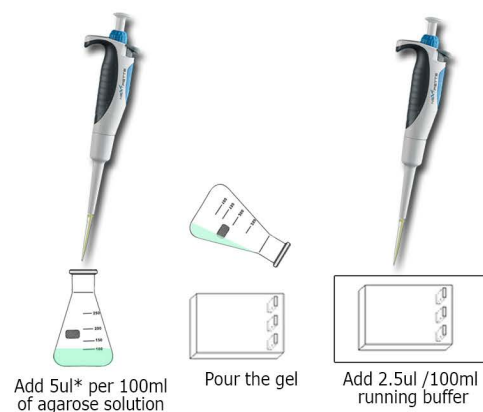

Protocol:

- Prepare 100ml of agarose (heat as required) or 100ml polyacrylamide solution.
 - For agarose, allow the solution to cool to about 60°C to 70°C.
 - Add 5µl* of SmartGlow™ stain to the gel solution.
 - Mix gently, make sure there are no air bubbles, pour the gel(s).
 - For best results, add 5µl of SmartGlow™ stain to each 100ml of running buffer.
 - Adding the stain to the running buffer increases sensitivity.
 - After the separation is complete, view the gel using a UV, blue light illuminator, or SmartDoc system.
- * If DNA/background fluorescence is too high, use 2.5µl/100ml.

SmartGlow™ is for research use only

Ordering Information:
E4500-PS 1.0m SmartGlow™ Pre Stain,
for Nucleic Acid Electrophoresis Gels, 20,000X
Storage: 4°C for 2 years



P.O. Box 709 Edison, NJ 08818 USA
Ph: 908-769-5555 EM: info@accuris-usa.com



SmartGlow™ Pre Stain, for Nucleic Acid Electrophoresis Gels, Concentration 20,000X

E4500-PS

SmartGlow™ Pre Stain can be used the same way as Ethidium Bromide for agarose and polyacrylamide gel electrophoresis. The stain emits green fluorescence when bound to dsDNA, ssDNA, and RNA. SmartGlow™ stain has two excitation peaks at approximately 290nm (UV light) and 475nm (Blue light).

SmartGlow™ Pre Stain is considered safer than Ethidium Bromide, and is non-carcinogenic as determined by the Ames-test, with negative results in mouse primary spermatocyte chromosomal aberration tests and mouse marrow chromophilous erythrocyte micronucleus tests. SmartGlow™ Pre Stain can be disposed as non-hazardous waste, and has passed the CCR Title 22 Hazardous Waste Test.

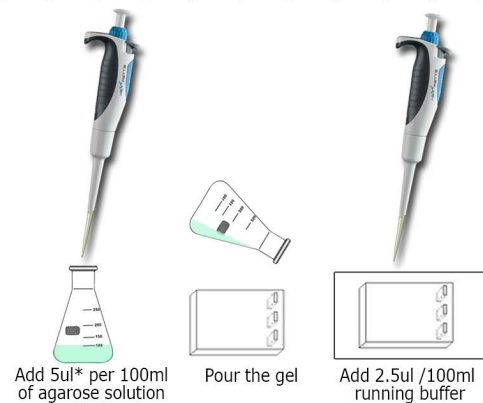

Protocol:

- Prepare 100ml of agarose (heat as required) or 100ml polyacrylamide solution.
 - For agarose, allow the solution to cool to about 60°C to 70°C.
 - Add 5µl* of SmartGlow™ stain to the gel solution.
 - Mix gently, make sure there are no air bubbles, pour the gel(s).
 - For best results, add 5µl of SmartGlow™ stain to each 100ml of running buffer.
 - Adding the stain to the running buffer increases sensitivity.
 - After the separation is complete, view the gel using a UV, blue light illuminator, or SmartDoc system.
- * If DNA/background fluorescence is too high, use 2.5µl/100ml.

SmartGlow™ is for research use only

Ordering Information:
E4500-PS 1.0m SmartGlow™ Pre Stain,
for Nucleic Acid Electrophoresis Gels, 20,000X
Storage: 4°C for 2 years



P.O. Box 709 Edison, NJ 08818 USA
Ph: 908-769-5555 EM: info@accuris-usa.com

Also available from Benchmark Scientific and Accuris Instruments:

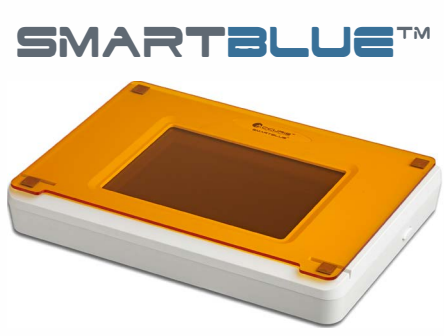

AGAROSE LE

- A1700 Benchmark Agarose LE, 25g
- A1701 Benchmark Agarose LE, 100g
- A1705 Benchmark Agarose LE, 500g

- E1101 MyGel Mini Electrophoresis System, complete with gel casting sets

- E4000 SmartBlue, blue light transilluminator

- E5001-SDB SmartDoc Gel Imaging System with blue light illumination
- E5001-SD SmartDoc Gel Imaging Enclosure (for use on existing transilluminators)

Contact us for more info or a price quote: www.accuris-usa.com - info@accuris-usa.com - 908-769-5555



Also available from Benchmark Scientific and Accuris Instruments:



AGAROSE LE

- A1700 Benchmark Agarose LE, 25g
- A1701 Benchmark Agarose LE, 100g
- A1705 Benchmark Agarose LE, 500g

- E1101 MyGel Mini Electrophoresis System, complete with gel casting sets

- E4000 SmartBlue, blue light transilluminator

- E5001-SDB SmartDoc Gel Imaging System with blue light illumination
- E5001-SD SmartDoc Gel Imaging Enclosure (for use on existing transilluminators)

Contact us for more info or a price quote: www.accuris-usa.com - info@accuris-usa.com - 908-769-5555

