

# ACR1601WNSF456



76.75" x 23.38" x 28.13" (H x W x D)

Upright healthcare all-refrigerator certified to NSF/ANSI 456 with self-closing solid door, front lock, digital controls, and NIST calibrated temperature readout

### Highlights:

Certified to NSF/ANSI 456 Vaccine Storage Standard

Specially designed to meet current CDC/VFC vaccine refrigeration guidelines for convenient storage in pharmacies, medical offices, and other healthcare facilities

External temperature readout of the current and high/low temperatures

### Product Features:

|  |  |
|--|--|
| EQTemp Healthcare Refrigerator                     | All-refrigerator designed to operate between 2 and 8°C for a variety of storage application in medical offices and other healthcare facilities   |
| Certified to NSF/ANSI 456 Vaccine Storage Standard | Tested to comply with the latest standards   |
| Certificate of calibration included                | The temperature monitoring device (TMD) is calibrated to NIST standards in our ISO/IEC 17025:2017 certified calibration laboratory and ships with a 2-year certificate of calibration for your records                                     |
| Factory installed lock                             | Keyed lock for a secure interior (2 keys included)   |
| Access port  | 3/8" probe hole with cover is pre-installed in unit's side to allow easy installation of user-provided monitoring equipment  |
| Buffered temperature probe                         | Thermometer probe is encased in a glass bead-filled bottle and stored in a fixed box on the center shelf. This is the ideal way to produce temperature readings closest to stored contents, as recommended by the CDC and VFC's guidelines |
| High/low temperature alarm                         | Thermometer probe is encased in a glass bead-filled bottle and stored in a fixed box on the center shelf. This is the ideal way to produce temperature readings closest to stored contents, as recommended by the CDC and VFC's guidelines |

External temperature readout Audible alarm sounds if the interior temperature rises or falls out of set range



## ACR1601WNSF456 Specifications:

| Overview                   |                      |
|----------------------------|----------------------|
| Height of Cabinet          | 76.75" (195 cm)      |
| Width                      | 23.38" (59 cm)       |
| Width with Door Open       | 23.63" (60 cm)       |
| Depth                      | 28.13" (71 cm)       |
| Depth with door at 90°     | 28.38" (72 cm)       |
| Capacity                   | 15.53 cu.ft. (440 L) |
| Defrost Type               | Automatic            |
| Door                       | White                |
| Cabinet                    | White                |
| US Electrical Safety       | ETL                  |
| Canadian Electrical Safety | ETL-C                |
| Sanitation                 | ETL-S to NSF 456     |
| Amps                       | 2.0                  |
| Voltage/Frequency          | 115 V AC/60 Hz       |
| Weight                     | 143.0 lbs. (65 kg)   |
| Shipping Weight            | 236.5 lbs. (107 kg)  |
| Parts & Labor Warranty     | 1 Year               |
| Compressor Warranty        | 5 Years              |
| UPC                        | 761101083117         |
| Refrigerator Features      |                      |
| Door Swing                 | RHD                  |
| Reversible                 | Factory Reversible   |
| Height Adjustable          | No                   |
| Shelf Type                 | Wire                 |
| Shelf Qty                  | 6                    |
| Adjustable Shelves         | Yes                  |
| Thermostat Type            | Digital              |
| Fan Type                   | Interior             |
| Refrigerant Type           | R600a                |
| Refrigerant Amount         | 2.0oz.               |
| High Side PSI              | 1.45                 |
| Low Side PSI               | 0.85                 |
| Level Legs Qty             | 2                    |
| Interior Light             | Yes                  |
| Temperature Range          | 2° to 8°C            |
| Dimensions                 |                      |
| Interior Height            | 68.25" (173 cm)      |

|                        |               |
|------------------------|---------------|
| Interior Width         | 20.0" (51 cm) |
| Interior Depth         | 21.5" (55 cm) |
| Compressor Step Height | 9.0" (23 cm)  |
| Compressor Step Width  | 20.0" (51 cm) |
| Compressor Step Depth  | 8.0" (20 cm)  |

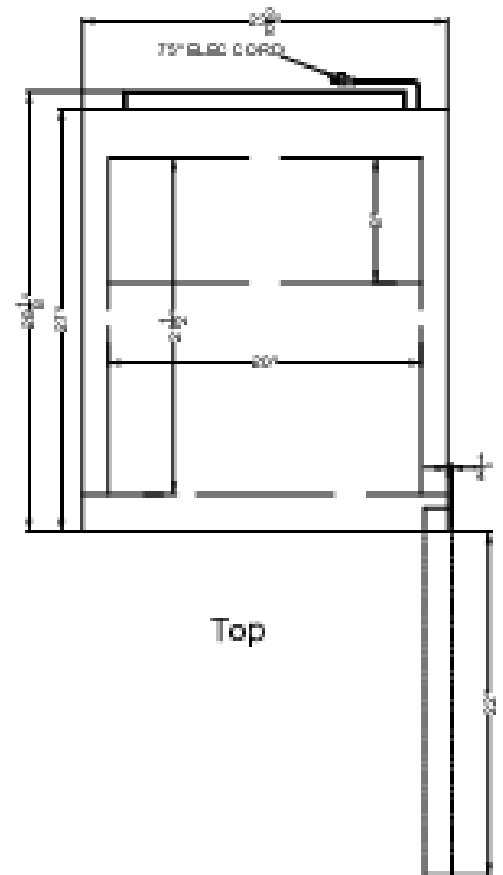

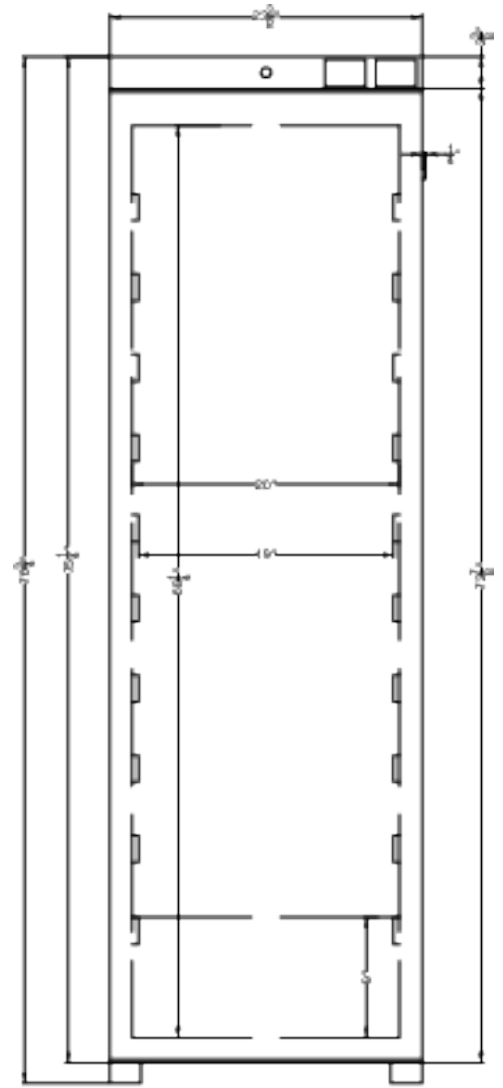

Front