

ACR1321WLHD



64.88" x 23.38" x 28.13" (H x W x D)

Upright healthcare all-refrigerator with self-closing solid door, front lock, digital controls, and external temperature readout

Highlights:

External temperature readout of the current and high/low temperatures

User-friendly front control panel keeps the thermostat and alarm in reach without having to open the door

Self-closing door protects interior products from ambient temperatures

Product Features:

EQTemp Healthcare Refrigerator	All-refrigerator designed to operate between 2 and 8°C for a variety of storage application in medical offices and other healthcare facilities
Temperature Range: 2° to 8°C	Preset to 5°C as recommended for many storage applications
External temperature readout	Includes continuous display of the current interior and high/low temperature, and can be switched from Celsius to Fahrenheit at the touch of a button
Large capacity	Full 12.71 cu.ft. capacity inside conveniently slim footprint
High/low temperature alarm	Audible alarm sounds if the interior temperature rises or falls out of set range
Buffered temperature probe	Thermometer probe is encased in a glass bead-filled bottle and stored in a fixed box on the center shelf. This is the ideal way to produce temperature readings closest to stored contents, as recommended by the CDC and VFC's guidelines
Temperature memory function	Unit will retain its last settings when power is restored in the event of power loss
Factory installed lock	Keyed lock for a secure interior (2 keys included)
Digital thermostat	Digital microprocessor for easy and precise temperature management, with all controls externally located for added convenience

ACR1321WLHD Specifications:

Overview	
Height of Cabinet	64.88" (165 cm)
Width	23.38" (59 cm)
Width with Door Open	23.63" (60 cm)
Depth	28.13" (71 cm)
Depth with door at 90°	50.13" (127 cm)
Capacity	12.71 cu.ft. (360 L)
Defrost Type	Automatic
Door	White
Cabinet	White
US Electrical Safety	ETL
Canadian Electrical Safety	ETL-C
Amps	2.0
Voltage/Frequency	115 V AC/60 Hz
Weight	130.0 lbs. (59 kg)
Shipping Weight	212.5 lbs. (96 kg)
Parts & Labor Warranty	1 Year
Compressor Warranty	5 Years
UPC	761101107578
Refrigerator Features	
Door Swing	LHD
Reversible	Factory Reversible
Shelf Type	Wire
Shelf Qty	5
Thermostat Type	Digital
Fan Type	Interior
Refrigerant Type	R600a
Refrigerant Amount	2.0oz.
High Side PSI	1.45
Low Side PSI	0.85
Level Legs Qty	2
Temperature Range	2° to 8°C
Sound Level	37.6 dB
Dimensions	
Interior Height	56.5" (144 cm)
Interior Width	20.0" (51 cm)
Interior Depth	21.5" (55 cm)
Compressor Step Height	9.0" (23 cm)

Compressor Step Width	20.0" (51 cm)
Compressor Step Depth	8.0" (20 cm)

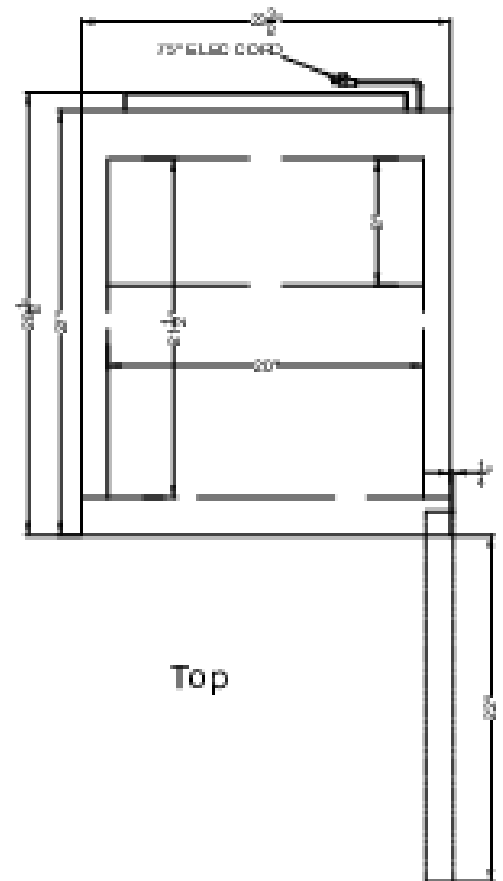

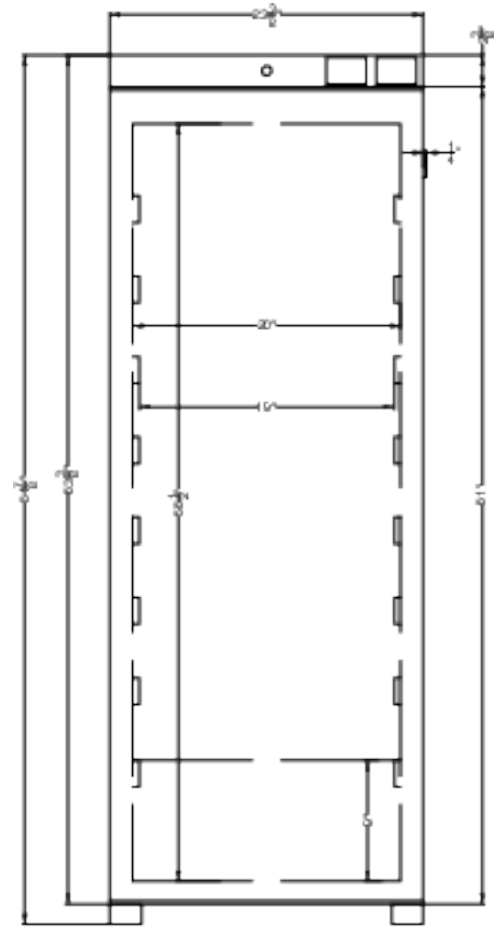

Front