



DLAB DM0636 Multi-Purpose Clinical Centrifuge is ideal for the centrifugation of samples in clinical chemistry, cytology, research laboratories, industrial laboratories, etc.

This centrifuge is suitable for tubes with caps, blood collection or urine tubes. Swing-out bucket rotors and adapters can be compatible with standard tubes up to 100 mL at low speed.

DM0636 Multi-Purpose Clinical Centrifuge

DM0636R Multi-Purpose Clinical Centrifuge Refrigerated

Features:

- Speed can be set from 300rpm to a max. of 6000 rpm
- Maximum capacity of the centrifuge: 100 mL x 4
- 9 Acceleration / 10 Brake speed settings to ensure optimal separation
- Powerful cooling system for precise temperature control of both chamber and samples(O636R)
- A wide range of accessories (fixed angle and swing-out bucket rotors)
- Automatic rotor identification
- Timer can be set up to 99 min. for short run / continuous run
- 9 procedures stored in memory makes the operation much simplified
- Maintenance-free brushless DC motors



CE FC



CE FC

Specifications

	DM0636	DM0636R
Speed range	300~6000rpm increment: 10rpm	300~6000rpm increment: 10rpm
Max. RCF	4300xg	4300xg
Speed accuracy	±20rpm	±20rpm
Temperature Range	-	-20~40°C
Rotor Capacity	9 types	9 types
Run Time	30sec~99mins/continue	30sec~99mins/continue
Motor	Brushless DC	Brushless DC
Display	LCD	LCD
Program Memory	9	9
Safety Devices	door,imb,motor over hot,speed over,chamber over temper	door,imb,motor over hot,speed over,chamber over temper
Acceleration/Braking time	9s ↑ / 10 ↓	9s ↑ / 10 ↓
Power	Single-phase AC220V~240V, 50Hz/60Hz, 6.3A; AC110V~120V,50Hz/60Hz, 10A	Single-phase AC220V~240V, 50Hz/60Hz, 12.5A; AC110V~120V,50Hz/60Hz, 15A
Dimension[WxDxH]	445x579x269mm	630x579x269mm
Weight	36kg	50kg
Certification	CE cTUVus FCC IVD	CE cTUVus FCC IVD
Advanced features	speed/rcf switch; Rotor identification	speed/rcf switch; Rotor identification

DM0636 series | Rotors and Adapters



Uncapping block

for S4-100 rotor



SE4-100(Standard accessory) for DM0636 & DM0636R

Cat. No. 19400041

Max. speed :4000rpm

Max. RCF:2830×g

Rotor material:stainless steel body and adaptor

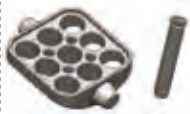

19400045



19400044



19400043



19400042

bucket	x 4											
tube	x 36		x 16			x 8	x 4	x 4	x 8	x 8	x 20	
Nominal volume	3~7mL		10mL	12mL	15mL	50mL	100mL	85mL	50mL	15mL	3~7mL	
φ×L mm	13×75	13×100	15×100	17×105	17×120	34×100		38×104	34×100	17×120 13×100 13×75	13×100 13×75	
tube												
adapter	with plug											
								A100P80	A100P50	A100P15	A100P10	
Package	36							4	4	4	4	
Tubes per rotor	36	36	16	16	16	8	4	4	8	8	20	
Radius(mm)	14	16.5	15.9	15.9	15.9	15.9	15.9	15.9	15.9	15.1	14.7	
Max rcf (g-force)	2500	2950	2840	2840	2840	2840	2840	2840	2840	2700	2630	

DM1636 series | Rotors and Adapters



AS12-PCR8 for D1536 & D1536R

Cat. No. 19400036

Max. speed :14000rpm
Max. RCF:21910×g
Rotor capacity:PCR 8 trips×12
Rotor material:aluminum
Bio-safe(Bio sealing):YES



AS30-2(Default) for D1536 & D1536R

Cat. No. 19400034

Max. speed :15000rpm
Max. RCF:25150×g
Rotor capacity:2mL×30
Rotor material:aluminum
Bio-safe(Bio sealing):YES



AS60-2 for D1536 & D1536R

Cat. No. 19400037

Max. speed :14000rpm
Max. RCF:21910×g
Rotor capacity:2mL×60
Rotor material:aluminum
Bio-safe(Bio sealing):YES



S2-MP for D1536 & D1536R

Cat. No. 19400062

Max. speed :4000rpm
Max. RCF:2200×g
Rotor capacity:Micro-plants 384-PCR; 96-PCR
Rotor material:stainless steel body and aluminum buckets

DM0636 series | Rotors and Adapters



AS6-50V

Cat. No. 19400038

for DM0636 & DM0636R

Max. speed :12500rpm
 Max. RCF:18690×g
 Rotor capacity:50mL×6
 Rotor material:aluminum
 Bio-safe(Bio sealing):YES



AS18-5V

Cat. No. 19400035

for DM0636 & DM0636R

Max. speed : 15000rpm
 Max. RCF: 25150×g
 Rotor capacity: 5mL×18
 Rotor material:stainless steel body and aluminum buckets



A8-50

Cat. No. 19400039

for DM0636 & DM0636R

Max. speed : 5000rpm
 Max. RCF: 3460×g
 Rotor capacity: 50mL×8 or 15mL×16
 Rotor material:aluminum body and stainless steel adaptor



A30-15

Cat. No. 19400040

for DM0636 & DM0636R

Max. speed :4500rpm
 Max. RCF:2570×g
 Rotor capacity:15mL×30
 Rotor material:aluminum body and stainless steel adaptor
 Bio-safe(Bio sealing):YES

Capacity	3~7mL Blood collection tube	10mL Blood collection tube	12mL urine tube	15mL
φ×L mm	13×75	13×100	17×105	17×120
Tubes Quantity	30	30	30	30