

Mixer Guide

Caframo[®]
LabSolutions



The Crossover

- Make your job easy - A fully featured mixer
Powerful, portable plug-in installation
- Capture data - Speed, torque, time, date
- Mix batches - Media, buffers, creams
No motor burn out
- Build into a modular system and control
by a PLC - LabVIEW compatible
- Safety certified to applicable standards

Built for Real Work

- High efficiency, 300 watts at shaft
- Brushless DC motor - fan cooled
- Overload and overheat protected



Caframo[®]
LabSolutions

	1540
Speed rpm	50-1500
Volume L (gal)	200 (55)
Viscosity cP	180,000
Torque Ncm	3,000
Horsepower	1/2
Weight kg (lbs)	12 (26.5)
Voltage	120 volt
Work Smart	<ul style="list-style-type: none">• Digital Data Collection• Auto Start Automation• Through Shaft Adjustment• Timer Notifications• Rotation Selection
Includes: 1540 mixer, chuck, key and guard, screen protector, USB, mounting hardware and tools, grounded cord, manual, calibration certificate. Three year warranty.	

**“A powerful and capable stirrer...
Our Techs are quite impressed”**

Selection Menu

GUI Resistive Touch Control

- Operate with a gloved hand
- Large visibility of settings
- Speed control on home screen

Settings Menu

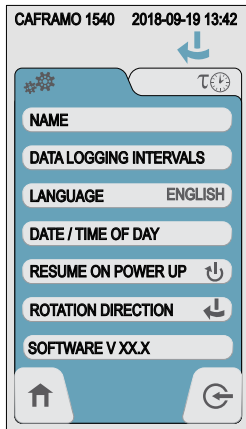

Torque Timer Menu

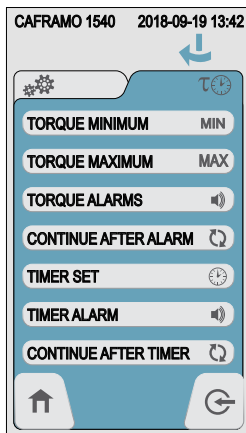

Set-up Accessories

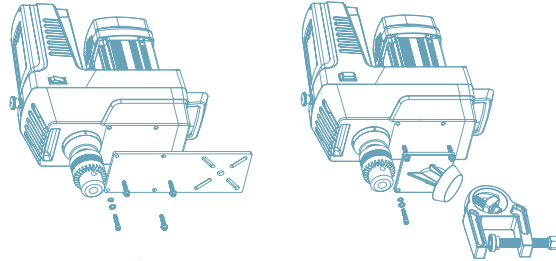

A129 Plate Mount

- 260 x 100 mm (10 x 4 in)
- 6.4 mm (¼ in) thickness
- 304 electropolished stainless steel

Sturdy simple mounting solution. Secure to existing horizontal surfaces, mixing equipment, drum brackets or industrial stands. Slotted bolt pattern provides adjustability when mounting.

A128SET C-Clamp Set

- Single bolt adjusts angle on two axes
- Attaches directly to a drum, frame or stand
- Cast 304 electropolished stainless steel

Mount the Caframo Crossover mixer to any stable vertical including an industrial stand, drum or vessel. Easy single bolt adjustment for multi-angle positioning.

Set includes c-clamp, clamp adapter and hardware. Standard tool installation.



A118 Stand with Casters

- Adjustable 99 to 145 cm (39 to 57 in) height
- 102 x 102 cm (40 x 40 in) caster footprint
- Plate steel, square tube construction

This manual lift, heavy duty stand and base provides a solid mount for the Caframo Crossover when mixing in drums or tanks up to 122 cm (48 in) in diameter. This stand comes with smooth rolling casters that swivel and lock in place.



[Download template for mounting.](#)

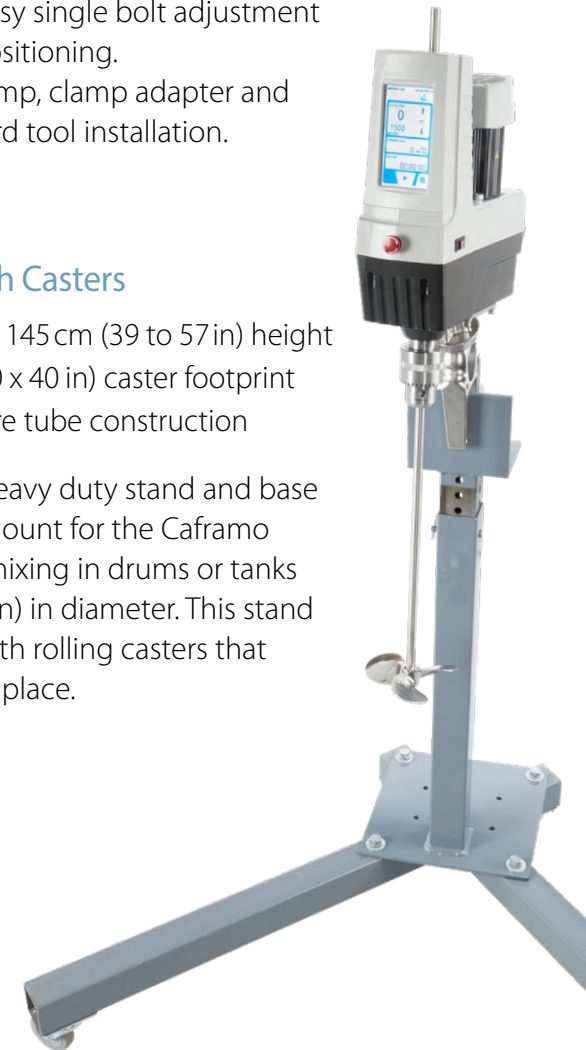

Accessories



Communication Ports

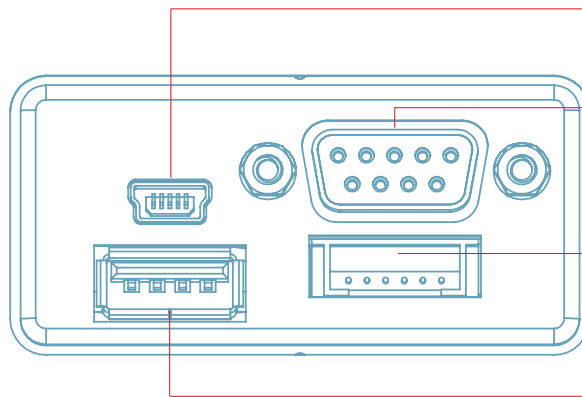

Mini USB

PC Control - communicate using command set.

DB9 Serial Port - RS232

PC or PLC Control and legacy ethernet connectivity. Adapt to RS485 and daisy chain mixers together.

Analog 4-20 mA

Stable PLC control over long distances. Simple wiring scheme widely used in industry.

Standard USB

Data logging and software updates. Process starts as soon as memory stick is inserted.



CG6	A354	A356	A016SET
Chuck Shaft Guard	Propeller with Shaft	Propeller with Shaft	Chuck Set
<ul style="list-style-type: none"> Polycarbonate ABS Simple mounting Safety accessory 	<ul style="list-style-type: none"> 102 (4) dia blade 914 x 12.5 (36 x 1/2) shaft 316L SS welded and polished 	<ul style="list-style-type: none"> 152 (6) dia blade 914 x 12.5 (36 x 1/2) shaft 316L SS welded and polished 	<ul style="list-style-type: none"> Shafts up to 16 (5/8) dia Through shaft 420 SS

mm (in)